

Post:

1. Take the posts out of the box and open out the legs.
2. Position them at a distance of approx. 1.2 m apart.

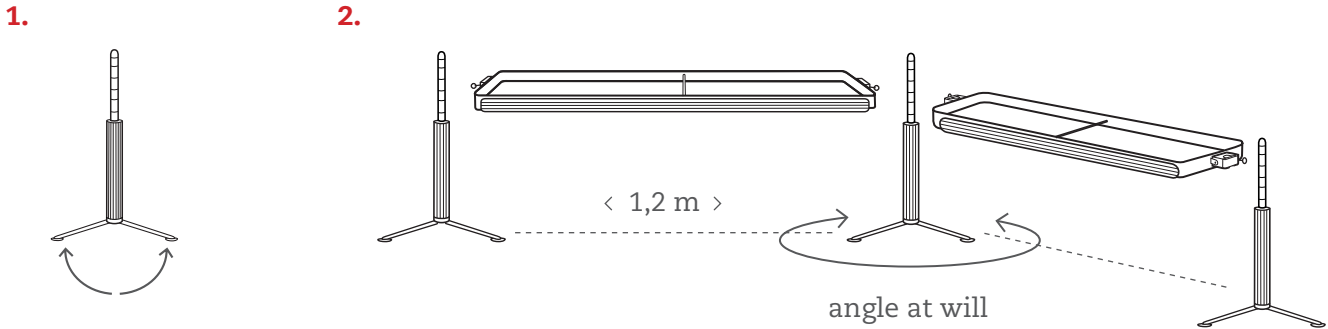

Wing:

Now fit the wings inbetween the posts at the desired height:

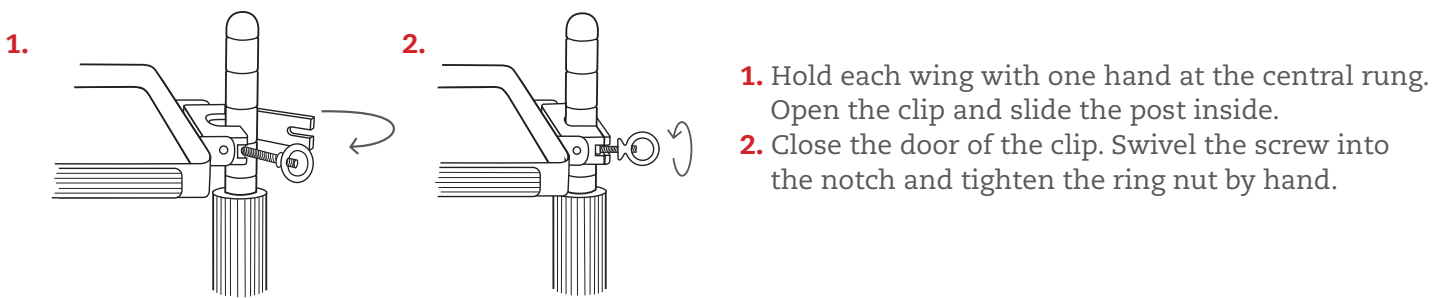

Glass dishes:

1. For the “glass stairs”, attach the wing at a tilt.
2. Fit 3 bars into the 1st, 3rd and 5th pair of holes, beginning from the bottom end.
3. Place the glass bowls onto.

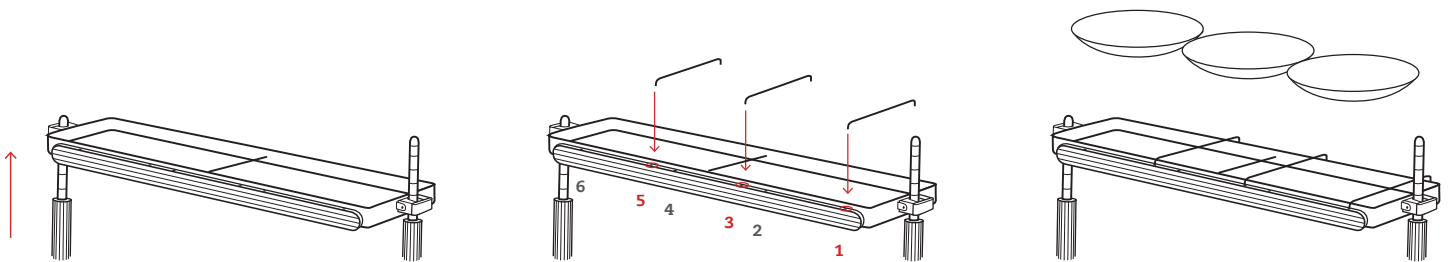

Chafing dishes / table boards:

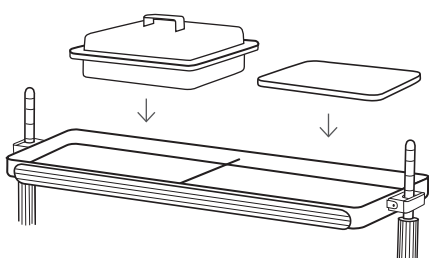

1. Attach the wing horizontally.
2. Fit in chafing dishes (without frame) into the wing / place table boards onto the wing.
3. Heaters of the chafing dishes are attached directly at the water pan.

Packing the box

1. Level / Ground:

2 x Post shelf

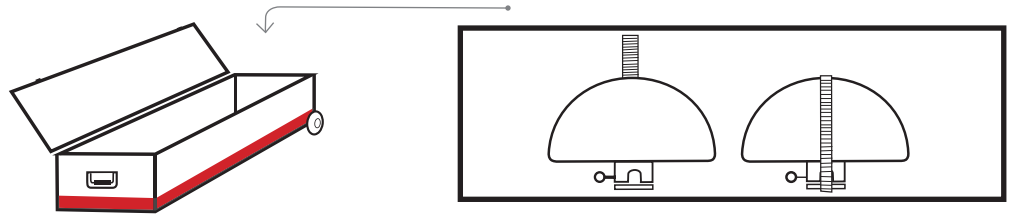

2. Level / Middle:

2 x Wing

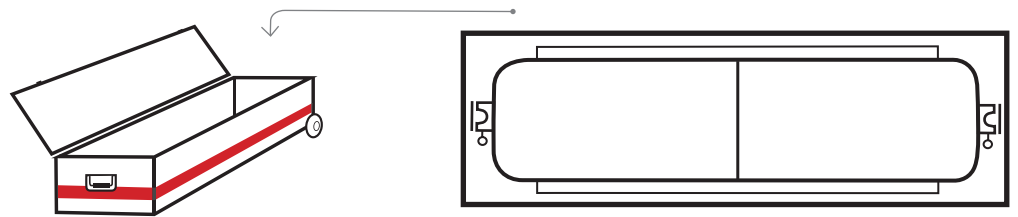

3. Level / Middle

2 x Table board

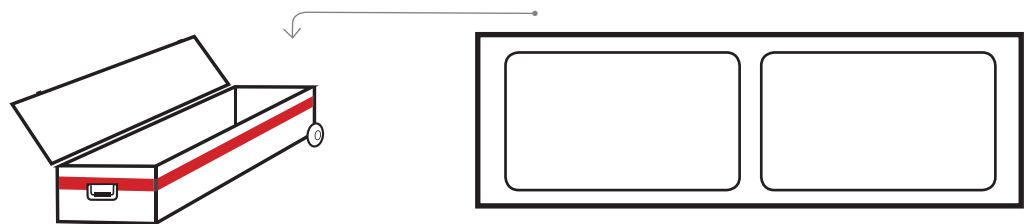

4. Level / Top:

3 x Post

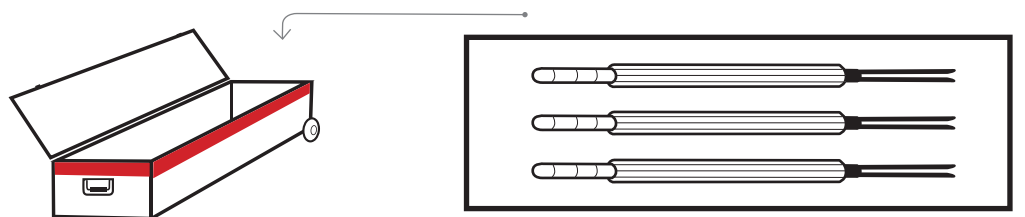

5. Bag:

6 x Bars (stainless steel)
2 x Cable clip

